

Segno System

BSU98510DA - Module for pendant mounting - uplight / downlight - single switch - 2250 mm. - 48+24 W - 4000 K / 4000 K / CRI > 91

DESCRIPTION

Segno System allow to create linear lighting effects without breaks. It is designed in different configuration to different ceiling, pendant, wall, trimless recessed mounting. It is composed by lighting modules which must be completed with the appropriate mounting accessories as a function of the type of installation to be carried out. The installation of the lighting modules in a continuous line is achieved thanks to the special mechanical joints "Junction Driven" which ensure better precision in the alignment of the bars. The lighting modules are pre-wired and can be equipped with different power systems, allowing full compatibility with all electrical systems. The lighting modules are already complete with optics modules (lenses+led) which are fixed by magnets, and the connection is made thanks to a quick connection plug. The optical modules are preassembled and protect the LEDs from any possible accidental contact even during the installation.

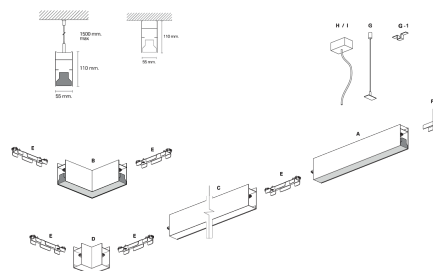

Switch

DALI

PRODUCTS CHARACTERISTICS

| | |
|----------------------------------|---------------------|
| installation type | Linear light |
| material | Aluminum |
| Finish | Painted |
| Color | White |
| Power | 48+24 W |
| Lumen output - Direct emission | 8840 lm |
| Lumen output - Indirect emission | 3425 lm |
| Lumen output - Full emission | 12265 lm |
| Efficacy | 170 lm/W |
| Dimensions | 2250 mm. |

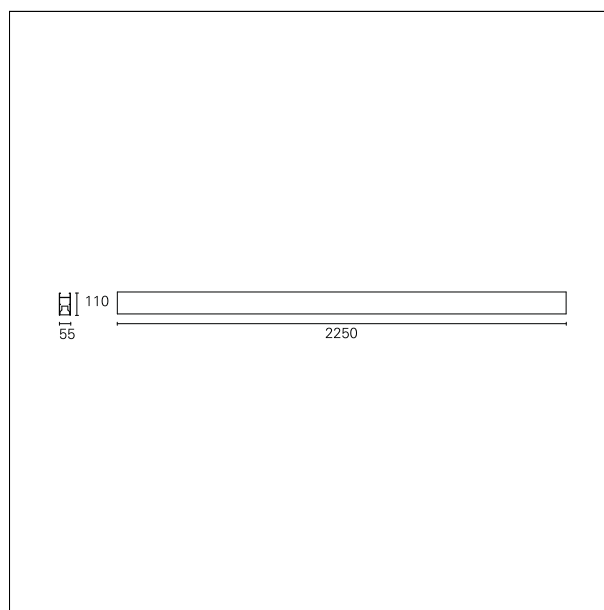

ELECTRICAL CHARACTERISTICS

| | |
|------------------|------------------|
| feeding | 220÷240 V |
| driver | DALI |
| Insulation class | Class I |

Segno System

BSU98510DA - Module for pendant mounting - uplight / downlight - single switch - 2250 mm. - 48+24 W - 4000 K / 4000 K / CRI > 91

MECHANICAL CHARACTERISTICS

product IP rate **IP40**

LED SOURCE DETAILS

| | |
|----------------------|------------------------------------|
| led source type | SMD Led |
| Photobiological risk | RG 1 Low risk (IEC 62471) |
| LED brand | TCI or equivalent |
| Service lifetime | L80 / B20 - 80.000 h. |
| Light temperature | 4000 K |
| CRI | CRI > 91 |
| SDCM | < 3 |

DRIVER CHARACTERISTICS

driver **DALI**

LIGHTING DETAILS

| | |
|-----------------------|--|
| emission | uplight/downlight (single switch) |
| Beam angle - direct | 60° |
| Beam angle - indirect | 60° |
| UGR | < 19 |

PHOTOMETRIC

